

MIT OpenCourseWare  
<http://ocw.mit.edu>

11.307 Beijing Urban Design Studio  
Summer 2008

For information about citing these materials or our Terms of Use, visit: <http://ocw.mit.edu/terms>.

## Revitalizing Shougang: urban agriculture as a social, economic, and physical force

MITsinghua Beijing Design Studio 2008

Group 5

Sandra Frem • Deborah Helaine Morris • Pamela Ritchot • Colin Zhao • Sara Zheng

# problems

explosive and sprawling growth  
loss of industrial economy  
site contamination  
integrity of industrial structures  
dependence on imported food products

# solution

develop a new global center for research surrounding brownfield remediation and urban agricultural production

chinese text here

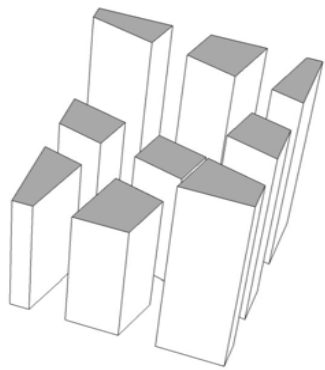

28% increase in population

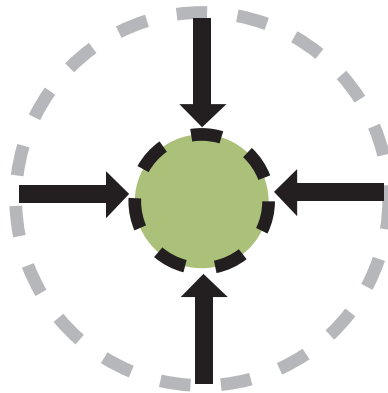

32% decrease in agricultural land



skyrocketing food prices

rapid population growth creates conflicting land use demands

chinese text here

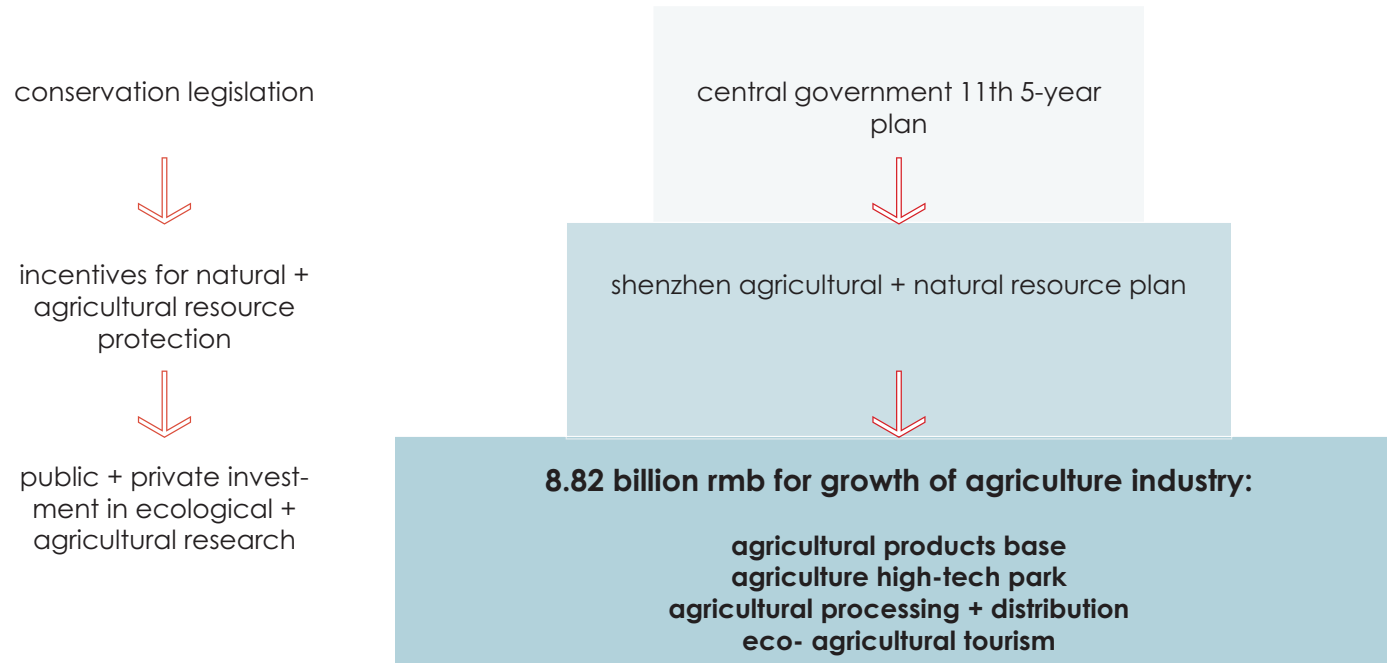

case study: shenzhen

MITsinghua Beijing Design Studio 2008

Group 5

Sandra Frem • Deborah Helaine Morris • Pamela Ritchot • Colin Zhao • Sara Zheng

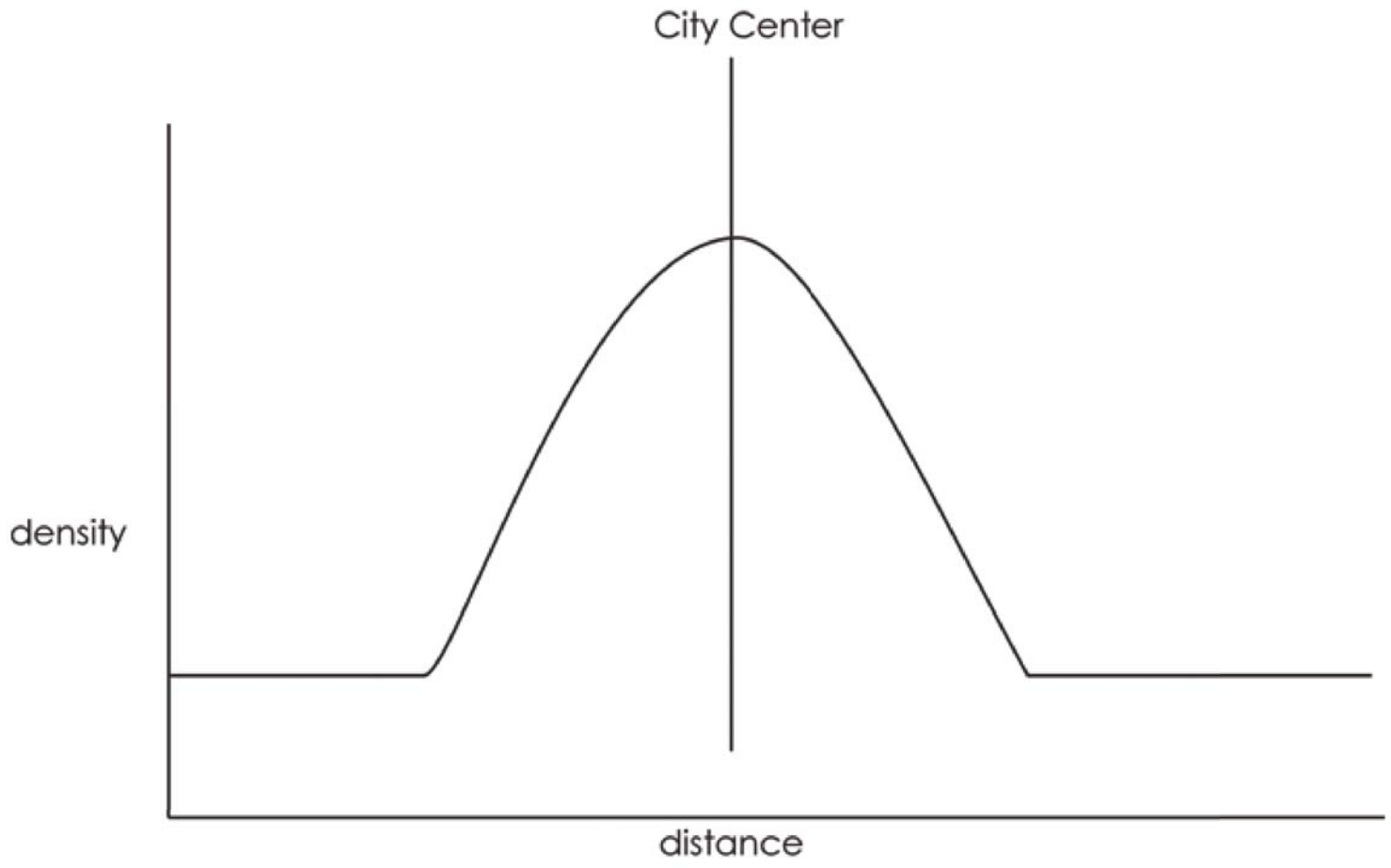

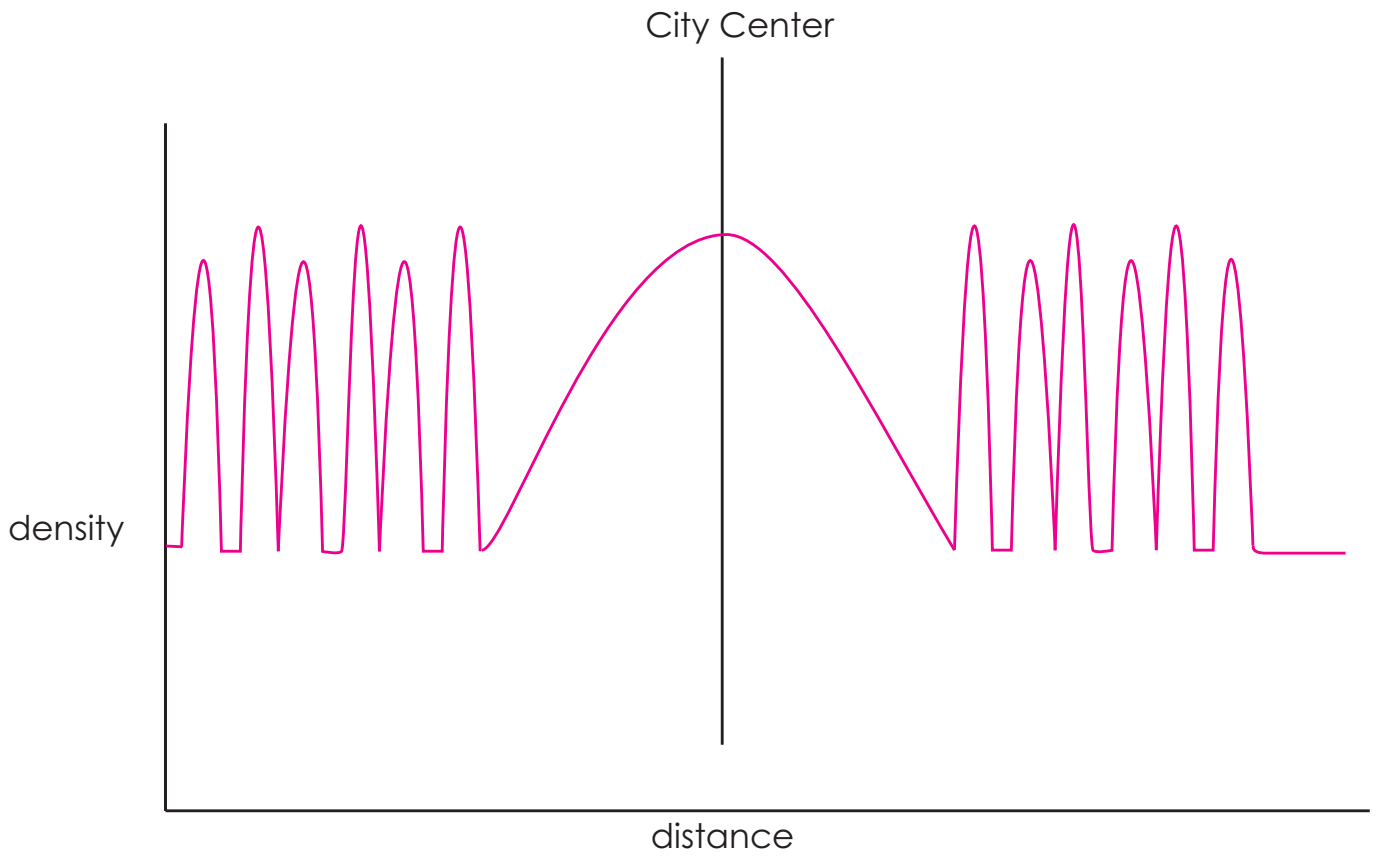



chinese text here



China's national agricultural research system is the largest publicly funded and administered research system in the world. About 60,000 researchers and technicians work in about 400 research institutes and 70 agricultural universities distributed across China.

remediation + agriculture + research hub = international knowledge cluster

MITsinghua Beijing Design Studio 2008

Group 5

Sandra Frem • Deborah Helaine Morris • Pamela Ritchot • Colin Zhao • Sara Zheng

Catalysts



Industry



Revitalization

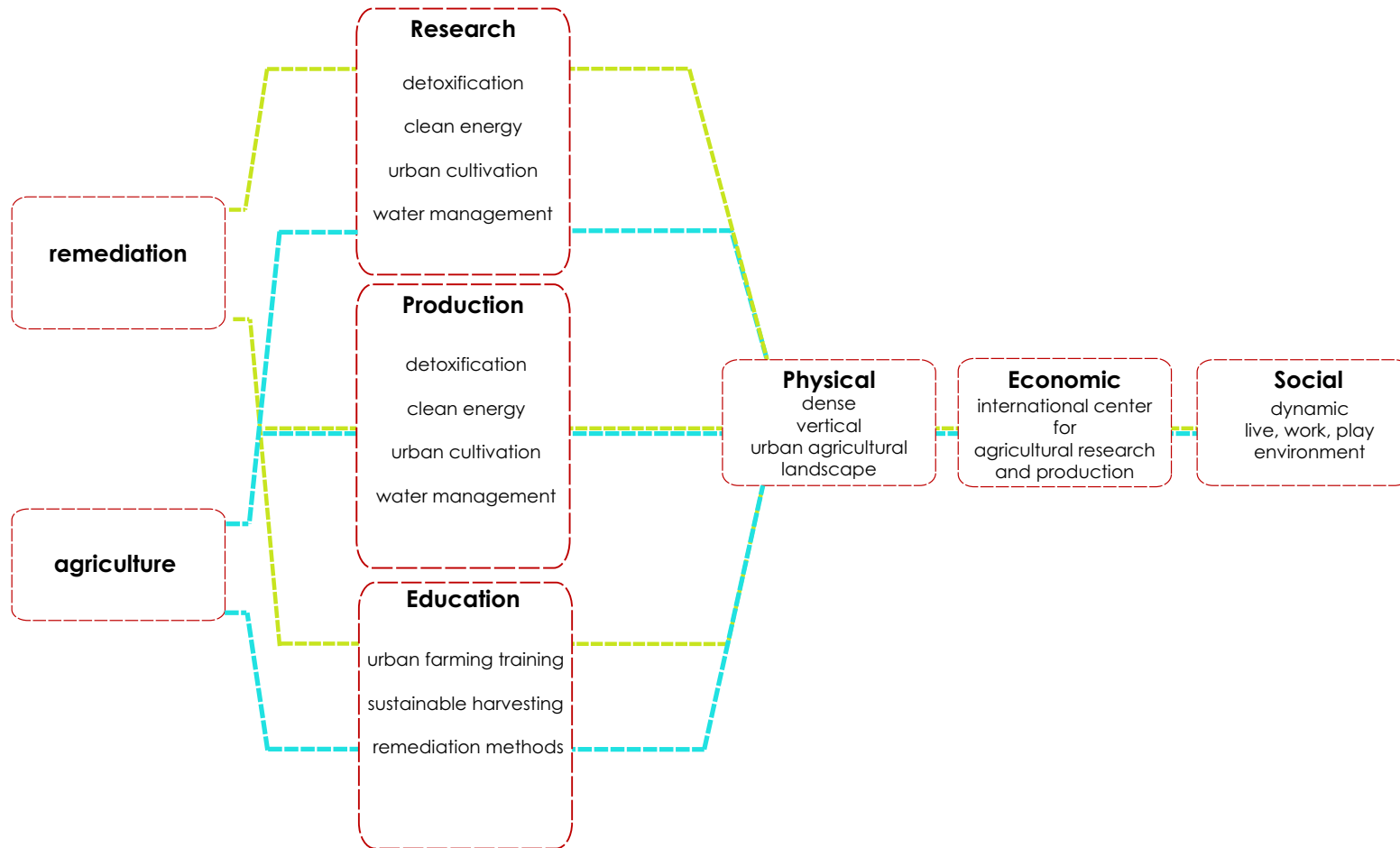

remediation + agriculture + research = international knowledge cluster



development projections:

- 40% research facilities
- 25% office facilities
- 5% education facilities
- 6% flat agricultural space
- 10% recreation space
- 3% retail spaces
- 1% convention space
- 10% residential units

employment types:

- land maintenance (unspecialized)
- land maintenance (specialized)
- agricultural workers (unskilled)
- custodians
- administrative support
- remediation lab technicians
- climate-control technicians
- researchers
- engineers
- agri-business technicians
- managers
- educators
- retail staff
- restaurant staff
- tourism service

MITsinghua Beijing Design Studio 2008

Group 5

Sandra Frem • Deborah Helaine Morris • Pamela Ritchot • Colin Zhao • Sara Zeng

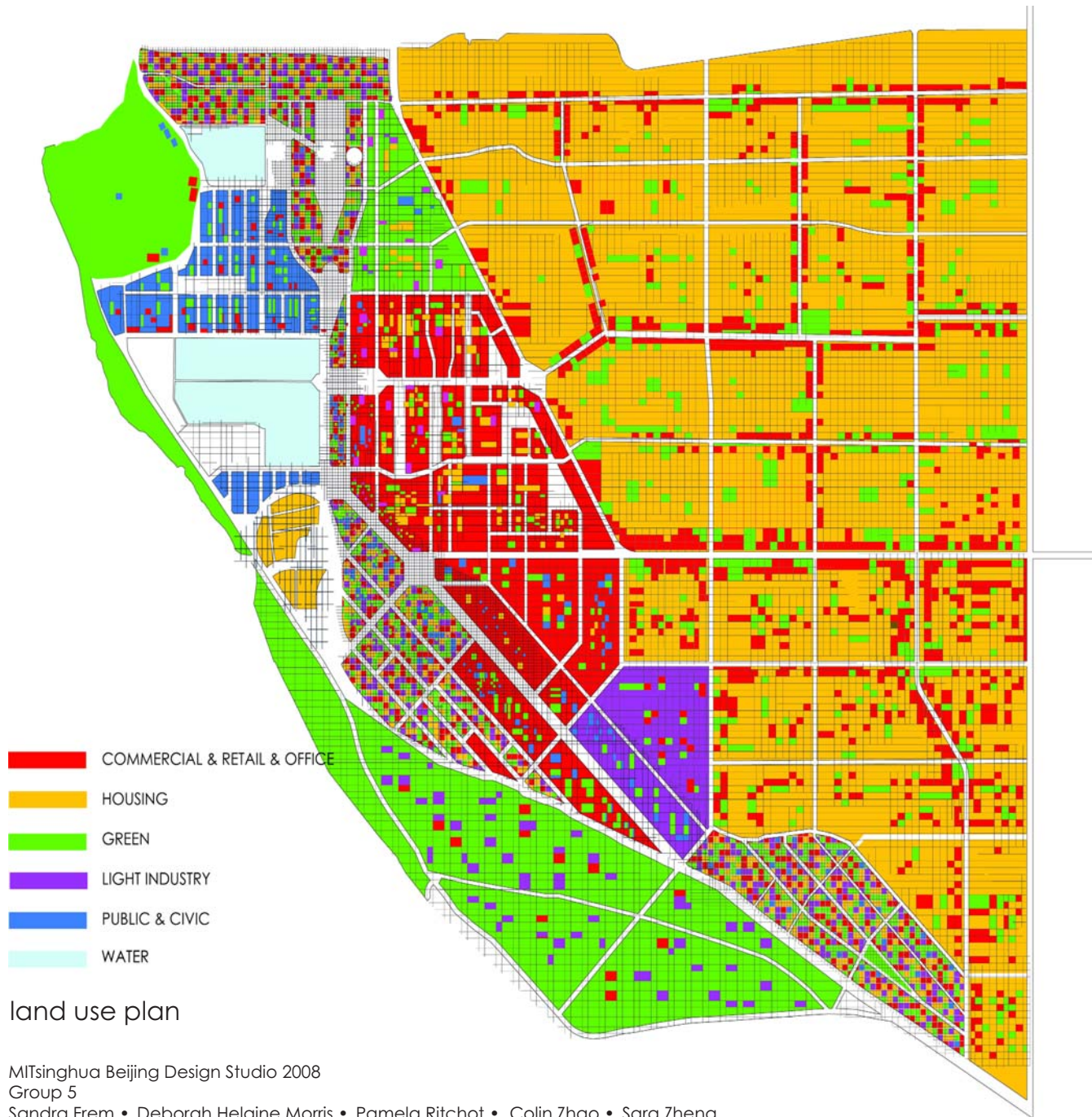

land use plan

MITsinghua Beijing Design Studio 2008  
Group 5

Sandra Frem • Deborah Helaine Morris • Pamela Ritchot • Colin Zhao • Sara Zheng

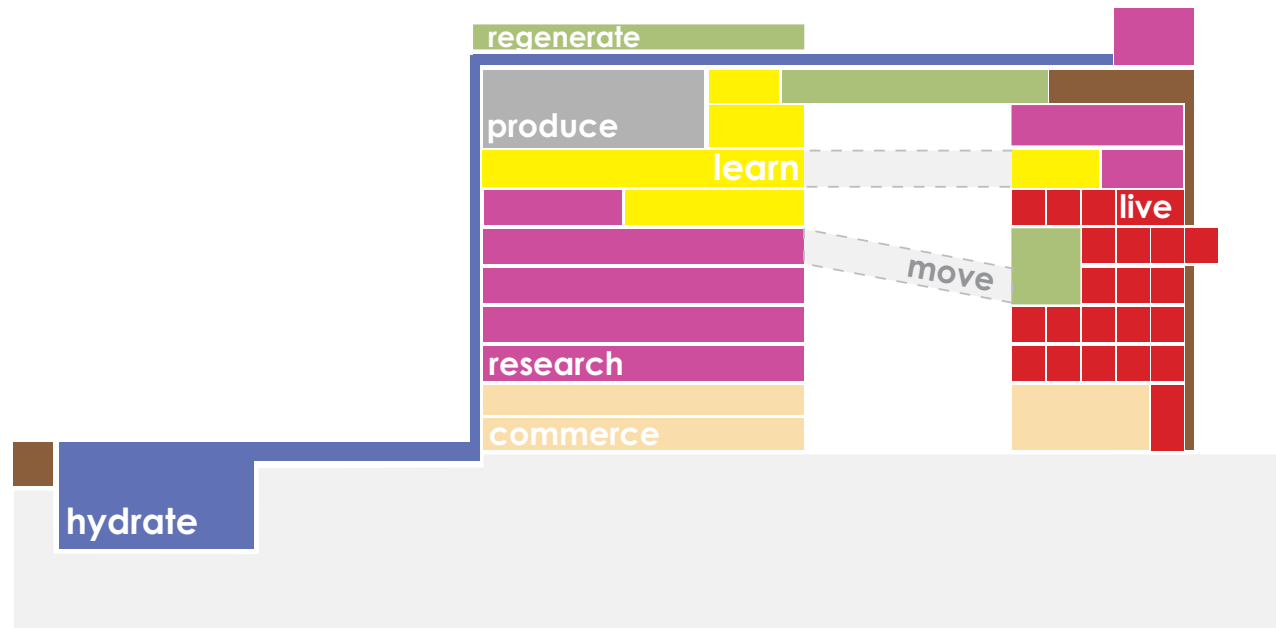
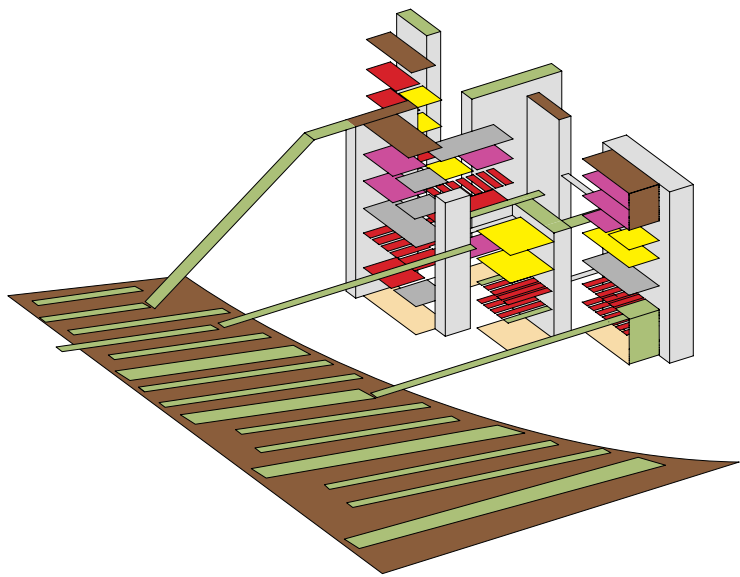

## opportunities of stacked uses

MITsinghua Beijing Design Studio 2008

Group 5

Sandra Frem • Deborah Helaine Morris • Pamela Ritchot • Colin Zhao • Sara Zeng

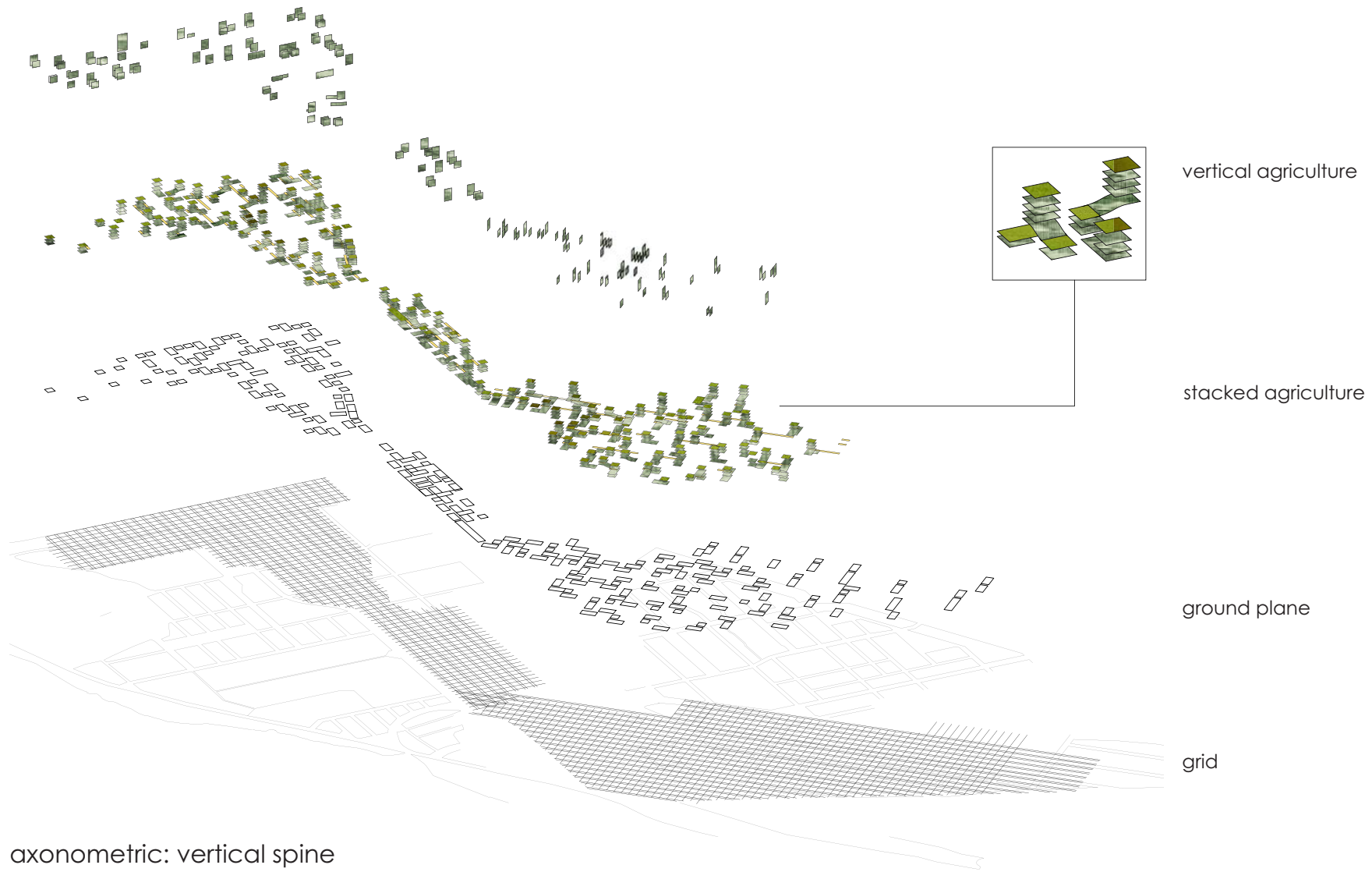

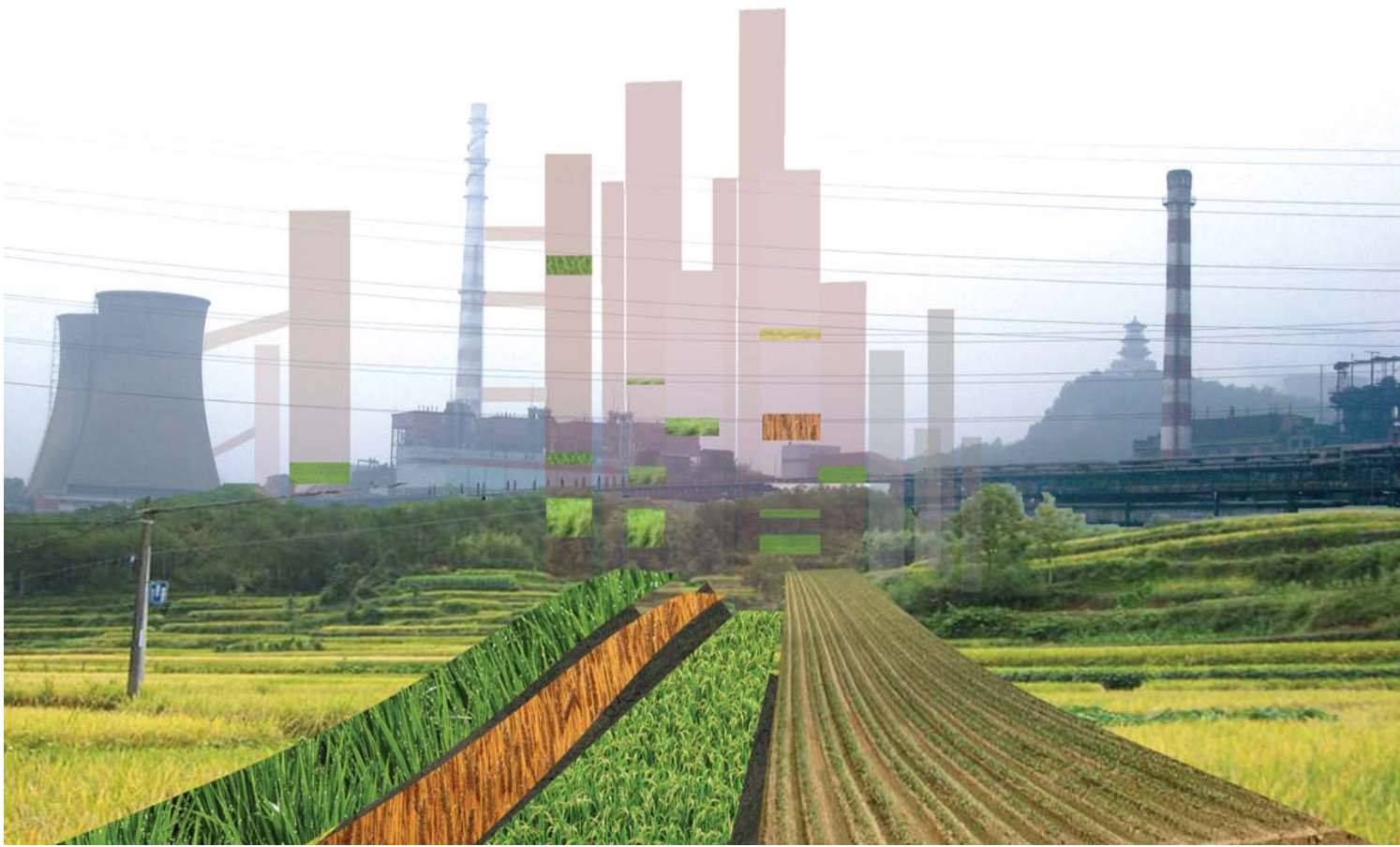

MITsinghua Beijing Design Studio 2008

Group 5

Sandra Frem • Deborah Helaine Morris • Pamela Ritchot • Colin Zhao • Sara Zeng

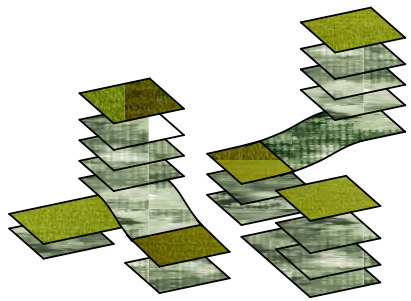
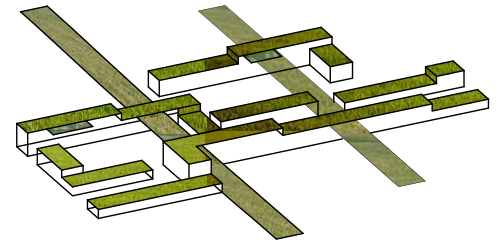
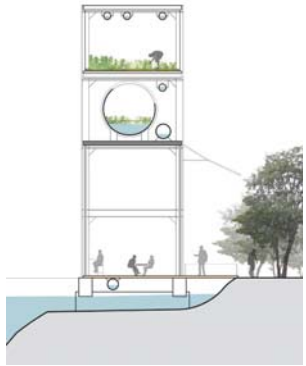
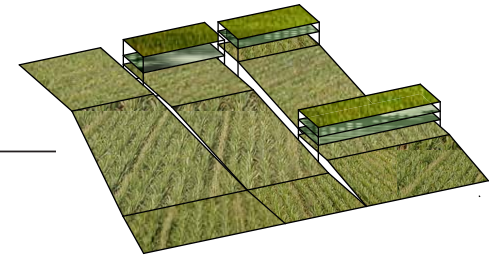
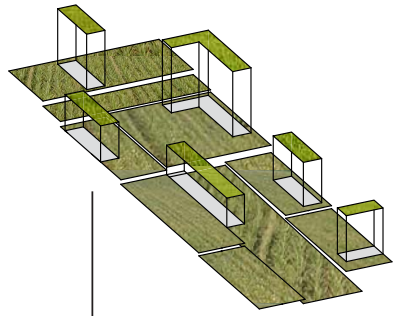

MITsinghua Beijing Design Studio 2008  
Group 5  
Sandra Frem • Deborah Helaine Morris • Pamela Ritchot • Colin Zhao • Sara Zeng





remediation crops:  
mustard, alfalfa, sunflowers, bamboo

food crops:  
soybeans, potatoes, cabbage and greens

suggested development:  
3,000,000 m<sup>2</sup> research facilities  
1,000,000 m<sup>2</sup> office facilities  
100,000 m<sup>2</sup> education facilities  
500,000 m<sup>2</sup> agriculture facilities  
10,000 m<sup>2</sup> retail spaces

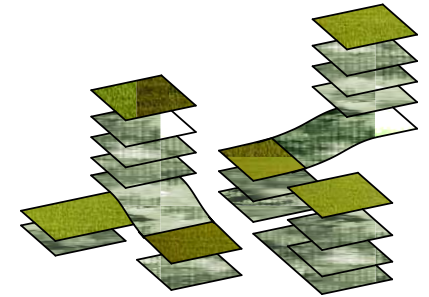

remediation crops:  
indian mustard, alfalfa, sunflowers, bamboo

food crops: soybeans, potatoes, cabbage and greens

development ratio:  
20% agriculture facilities  
30% recreation/open space  
15% tourism facilities  
20% residential units  
15% hotel rooms

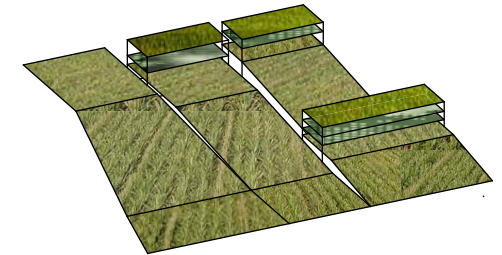

zones of development

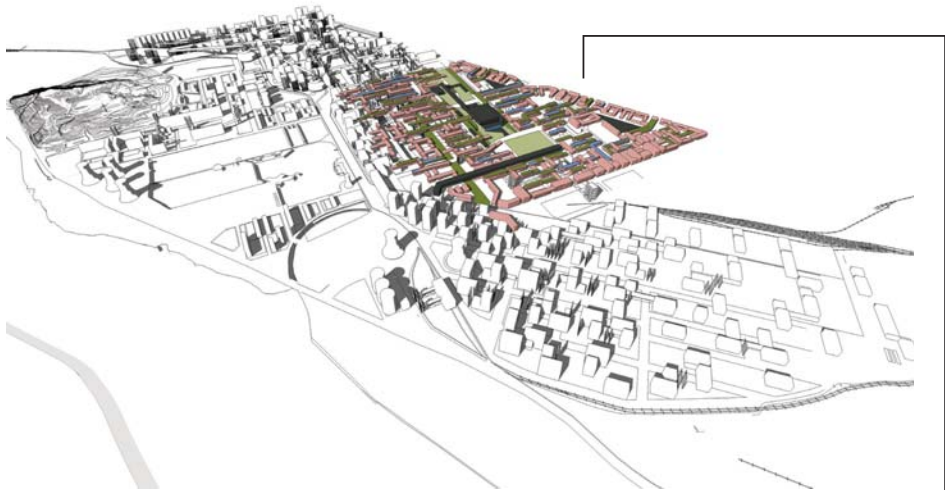

zones of development

key remediation crops:  
indian mustard, alfalfa, sorghum, barley, and rye

key agricultural products:  
soybeans, potatoes, cabbage, greens, fruits.

- suggested development:
- 1,000,000 m<sup>2</sup> research facilities
  - 1,000,000 m<sup>2</sup> office facilities
  - 100,000 m<sup>2</sup> agriculture facilities
  - 50,000 m<sup>2</sup> retail spaces
  - 100,000 m<sup>2</sup> convention space

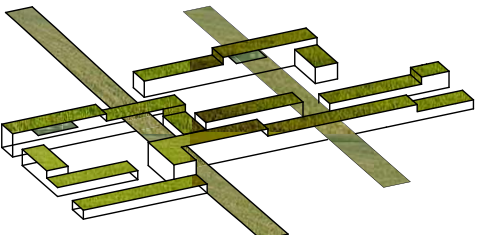



## section

MITsinghua Beijing Design Studio 2008

Group 5

Sandra Frem • Deborah Helaine Morris • Pamela Ritchot • Colin Zhao • Sara Zeng



## section

MITsinghua Beijing Design Studio 2008

Group 5

Sandra Frem • Deborah Helaine Morris • Pamela Ritchot • Colin Zhao • Sara Zeng