

2.008

QUALITY

Manufacture

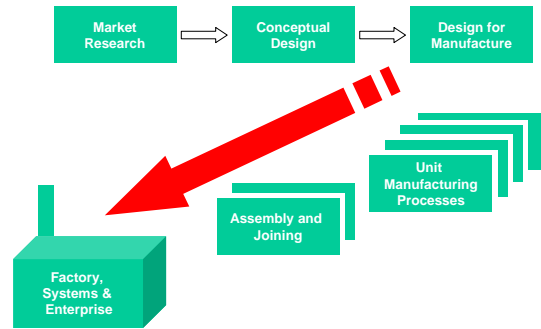

Outline

1. What is quality?
2. Variations
3. Statistical representation
4. Robustness

Read Chapter 35 & 36

What is quality?

Variations

1. Part and assembly variations
2. Variations in conditions of use
3. Deterioration

Variable Outcome

Results from measuring intermediate or final process outcome



Outcome examples

- Shaft O.D. (inches)
- Hole distance from reference surface (mm)
- Circuit resistance (ohms)
- Heat treat temperature (degrees)
- Railcar transit time (hours)
- Engineering change processing time (hours)

- Unit of measure (mm, kg, etc.)
- The measurement method must produce accurate and precise results over time

Technological Development

- Physical masters
- Engineering drawings
- Go / No-Go gage
- Statistical measurement
- Continuous on-line measurement

2.008 - Spring 2004

7

Engineered Part

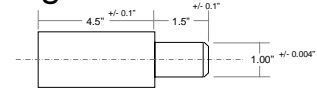

- Design specification
 $\pm 0.004"$
- Process specification

2.008 - Spring 2004

8

Engineered Part (cont'd)

- Raw data, n = 20

1.0013	0.9986	1.0015	0.9996
1.0060	0.9997	1.0029	0.9977
1.0042	0.9955	1.0019	0.9970
0.9992	1.0034	0.9995	1.0022
1.0020	0.9960	1.0013	1.0020

- 6 Buckets

.994 - .996	2
.996 - .998	2
.998 - 1.000	5
1.000 - 1.002	6
1.002 - 1.004	3
1.004 - 1.006	2

2.008 - Spring 2004

9

Engineered Part

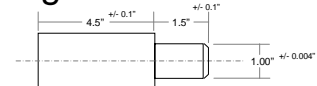

- Design specification
 $\pm 0.004"$
- Process specification

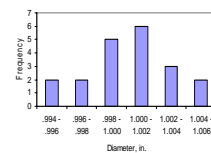

2.008 - Spring 2004

10

Manufacturing Outcome: Central Tendency

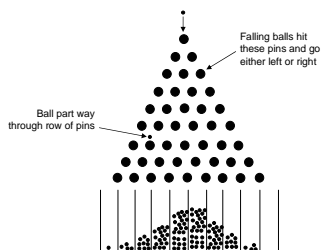

2.008 - Spring 2004

11

Central Tendency

Halloween M&M mass histograms: n = 100

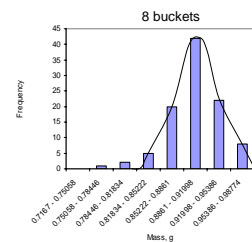

2.008 - Spring 2004

12

Dispersion

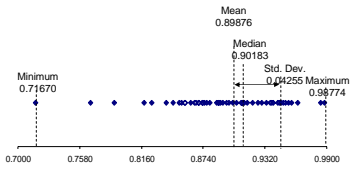

Mass of Halloween M&M's, g, n=100

Statistical Distribution

- Central tendency
 - Sample mean (arithmetic): $\bar{x} = \frac{\sum_{i=1}^n x_i}{n}$
 - Sample median
- Measures of dispersion
 - Standard deviation: $s = \sqrt{\frac{\sum_{i=1}^n (x_i - \bar{x})^2}{n}}$
 - Variance: $s^2 = \frac{\sum_{i=1}^n (x_i - \bar{x})^2}{n}$
 - Range

Normal Probability Density Function

$$f(x) = \frac{1}{\sqrt{2\pi}s} \cdot e^{-\frac{(x-\bar{x})^2}{2s^2}}$$

Probability

$$P\{a \leq x \leq b\} = \int_a^b f(x) dx$$

$$P\{-\infty < x < \infty\} = \int_{-\infty}^{\infty} f(x) dx = 1 \text{ For all } \bar{x}, s$$

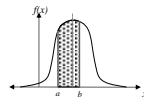

Normalized

$$z = \frac{x-\bar{x}}{s}$$

$$P\{z_1 \leq z \leq z_2\} = \int_{z_1}^{z_2} \frac{1}{\sqrt{2\pi}} e^{-\frac{z^2}{2}} dz$$

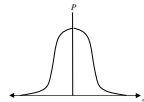

Areas under the Normal Distribution Curve

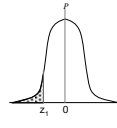

z	0	0.01	0.02	0.03	0.04	0.05	0.06	0.07	0.08	0.09
-3.9	0.0003	0.0003	0.0003	0.0003	0.0003	0.0003	0.0003	0.0003	0.0003	0.0003
-3.8	0.0003	0.0003	0.0003	0.0003	0.0003	0.0003	0.0003	0.0003	0.0003	0.0003
-3.7	0.0003	0.0003	0.0003	0.0003	0.0003	0.0003	0.0003	0.0003	0.0003	0.0003
-3.6	0.0003	0.0003	0.0003	0.0003	0.0003	0.0003	0.0003	0.0003	0.0003	0.0003
-3.5	0.0003	0.0003	0.0003	0.0003	0.0003	0.0003	0.0003	0.0003	0.0003	0.0003
-3.4	0.0003	0.0003	0.0003	0.0003	0.0003	0.0003	0.0003	0.0003	0.0003	0.0003
-3.3	0.0003	0.0003	0.0003	0.0003	0.0003	0.0003	0.0003	0.0003	0.0003	0.0003
-3.2	0.0003	0.0003	0.0003	0.0003	0.0003	0.0003	0.0003	0.0003	0.0003	0.0003
-3.1	0.0003	0.0003	0.0003	0.0003	0.0003	0.0003	0.0003	0.0003	0.0003	0.0003
-3.0	0.0003	0.0003	0.0003	0.0003	0.0003	0.0003	0.0003	0.0003	0.0003	0.0003
-2.9	0.0003	0.0003	0.0003	0.0003	0.0003	0.0003	0.0003	0.0003	0.0003	0.0003
-2.8	0.0003	0.0003	0.0003	0.0003	0.0003	0.0003	0.0003	0.0003	0.0003	0.0003
-2.7	0.0003	0.0003	0.0003	0.0003	0.0003	0.0003	0.0003	0.0003	0.0003	0.0003
-2.6	0.0003	0.0003	0.0003	0.0003	0.0003	0.0003	0.0003	0.0003	0.0003	0.0003
-2.5	0.0003	0.0003	0.0003	0.0003	0.0003	0.0003	0.0003	0.0003	0.0003	0.0003
-2.4	0.0003	0.0003	0.0003	0.0003	0.0003	0.0003	0.0003	0.0003	0.0003	0.0003
-2.3	0.0003	0.0003	0.0003	0.0003	0.0003	0.0003	0.0003	0.0003	0.0003	0.0003
-2.2	0.0003	0.0003	0.0003	0.0003	0.0003	0.0003	0.0003	0.0003	0.0003	0.0003
-2.1	0.0003	0.0003	0.0003	0.0003	0.0003	0.0003	0.0003	0.0003	0.0003	0.0003
-2.0	0.0003	0.0003	0.0003	0.0003	0.0003	0.0003	0.0003	0.0003	0.0003	0.0003
-1.9	0.0003	0.0003	0.0003	0.0003	0.0003	0.0003	0.0003	0.0003	0.0003	0.0003
-1.8	0.0003	0.0003	0.0003	0.0003	0.0003	0.0003	0.0003	0.0003	0.0003	0.0003
-1.7	0.0003	0.0003	0.0003	0.0003	0.0003	0.0003	0.0003	0.0003	0.0003	0.0003
-1.6	0.0003	0.0003	0.0003	0.0003	0.0003	0.0003	0.0003	0.0003	0.0003	0.0003
-1.5	0.0003	0.0003	0.0003	0.0003	0.0003	0.0003	0.0003	0.0003	0.0003	0.0003
-1.4	0.0003	0.0003	0.0003	0.0003	0.0003	0.0003	0.0003	0.0003	0.0003	0.0003
-1.3	0.0003	0.0003	0.0003	0.0003	0.0003	0.0003	0.0003	0.0003	0.0003	0.0003
-1.2	0.0003	0.0003	0.0003	0.0003	0.0003	0.0003	0.0003	0.0003	0.0003	0.0003
-1.1	0.0003	0.0003	0.0003	0.0003	0.0003	0.0003	0.0003	0.0003	0.0003	0.0003
-1.0	0.0003	0.0003	0.0003	0.0003	0.0003	0.0003	0.0003	0.0003	0.0003	0.0003
-0.9	0.0003	0.0003	0.0003	0.0003	0.0003	0.0003	0.0003	0.0003	0.0003	0.0003
-0.8	0.0003	0.0003	0.0003	0.0003	0.0003	0.0003	0.0003	0.0003	0.0003	0.0003
-0.7	0.0003	0.0003	0.0003	0.0003	0.0003	0.0003	0.0003	0.0003	0.0003	0.0003
-0.6	0.0003	0.0003	0.0003	0.0003	0.0003	0.0003	0.0003	0.0003	0.0003	0.0003
-0.5	0.0003	0.0003	0.0003	0.0003	0.0003	0.0003	0.0003	0.0003	0.0003	0.0003
-0.4	0.0003	0.0003	0.0003	0.0003	0.0003	0.0003	0.0003	0.0003	0.0003	0.0003
-0.3	0.0003	0.0003	0.0003	0.0003	0.0003	0.0003	0.0003	0.0003	0.0003	0.0003
-0.2	0.0003	0.0003	0.0003	0.0003	0.0003	0.0003	0.0003	0.0003	0.0003	0.0003
-0.1	0.0003	0.0003	0.0003	0.0003	0.0003	0.0003	0.0003	0.0003	0.0003	0.0003
0.0	0.0003	0.0003	0.0003	0.0003	0.0003	0.0003	0.0003	0.0003	0.0003	0.0003

Areas under the Normal Distribution Curve

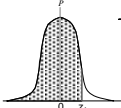

z	0	0.01	0.02	0.03	0.04	0.05	0.06	0.07	0.08	0.09
0.1	0.5398	0.5438	0.5478	0.5517	0.5557	0.5596	0.5636	0.5675	0.5714	0.5753
0.2	0.5793	0.5832	0.5871	0.5910	0.5948	0.5987	0.6026	0.6064	0.6103	0.6141
0.3	0.6179	0.6217	0.6255	0.6293	0.6331	0.6368	0.6406	0.6443	0.6480	0.6517
0.4	0.6554	0.6591	0.6628	0.6664	0.6700	0.6736	0.6772	0.6808	0.6844	0.6879
0.5	0.6915	0.6950	0.6985	0.7019	0.7054	0.7088	0.7123	0.7157	0.7190	0.7224
0.6	0.7257	0.7291	0.7324	0.7357	0.7389	0.7422	0.7454	0.7486	0.7517	0.7549
0.7	0.7580	0.7611	0.7642	0.7673	0.7704	0.7734	0.7764	0.7794	0.7823	0.7852
0.8	0.7881	0.7910	0.7939	0.7967	0.7995	0.8023	0.8051	0.8079	0.8106	0.8133
0.9	0.8159	0.8186	0.8212	0.8238	0.8264	0.8289	0.8315	0.8340	0.8365	0.8389
1.0	0.8413	0.8438	0.8461	0.8485	0.8508	0.8531	0.8554	0.8577	0.8599	0.8621
1.1	0.8643	0.8665	0.8686	0.8708	0.8729	0.8749	0.8770	0.8790	0.8810	0.8830
1.2	0.8849	0.8869	0.8888	0.8907	0.8925	0.8944	0.8962	0.8980	0.8997	0.9015
1.3	0.9032	0.9049	0.9066	0.9082	0.9099	0.9115	0.9131	0.9147	0.9162	0.9177
1.4	0.9192	0.9207	0.9222	0.9236	0.9251	0.9265	0.9279	0.9292	0.9306	0.9319
1.5	0.9332	0.9345	0.9357	0.9370	0.9382	0.9394	0.9406	0.9418	0.9429	0.9441
1.6	0.9452	0.9463	0.9474	0.9484	0.9495	0.9505	0.9515	0.9525	0.9535	0.9545
1.7	0.9554	0.9564	0.9573	0.9582	0.9591	0.9599	0.9608	0.9616	0.9625	0.9633
1.8	0.9641	0.9649	0.9656	0.9664	0.9671	0.9679	0.9686	0.9693	0.9699	0.9706
1.9	0.9713	0.9719	0.9726	0.9732	0.9738	0.9744	0.9750	0.9756	0.9761	0.9767
2.0	0.9772	0.9778	0.9783	0.9789	0.9793	0.9798	0.9803	0.9808	0.9812	0.9817
2.1	0.9821	0.9826	0.9830	0.9834	0.9838	0.9842	0.9846	0.9850	0.9854	0.9857
2.2	0.9861	0.9864	0.9868	0.9871	0.9875	0.9878	0.9881	0.9884	0.9887	0.9890
2.3	0.9893	0.9896	0.9898	0.9901	0.9904	0.9906	0.9909	0.9911	0.9913	0.9916
2.4	0.9918	0.9920	0.9922	0.9925	0.9927	0.9929	0.9931	0.9932	0.9934	0.9936
2.5	0.9938	0.9940	0.9941	0.9943	0.9945	0.9946	0.9948	0.9949	0.9951	0.9952
2.6	0.9953	0.9955	0.9956	0.9957	0.9959	0.9960	0.9961	0.9962	0.9963	0.9964
2.7	0.9965	0.9966	0.9967	0.9968	0.9969	0.9970	0.9971	0.9972	0.9973	0.9974
2.8	0.9974	0.9975	0.9976	0.9977	0.9977	0.9979	0.9979	0.9979	0.9980	0.9981
2.9	0.9981	0.9982	0.9982	0.9983	0.9984	0.9984	0.9985	0.9985	0.9986	0.9986
3.0	0.9987	0.9987	0.9987	0.9988	0.9988	0.9989	0.9989	0.9989	0.9990	0.9990

Normal Distribution Example

Take a M&M with mass = 0.9g, based on our calculated normal curve, how many M&M's have a mass greater than 0.9g?

$$Z = \frac{x - \bar{x}}{s}$$

$$Z = (0.9 - 0.89876) / 0.04255 = 0.29$$

Area to the right of Z=0.29, from table on previous page:
 $P = (1 - 0.6141) = 0.3859$

So, the number of M&M's with a mass greater than 0.9g
 $\# = P * n = 0.3859 * 100 = 39$

Robustness

Not accurate



Accurate



2.008 - Spring 2004

19

Robustness

A Tale of Two Factories

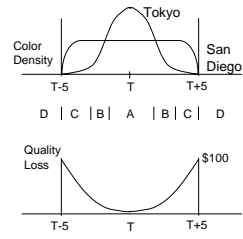

2.008 - Spring 2004

20